

# Proposed Site Plan

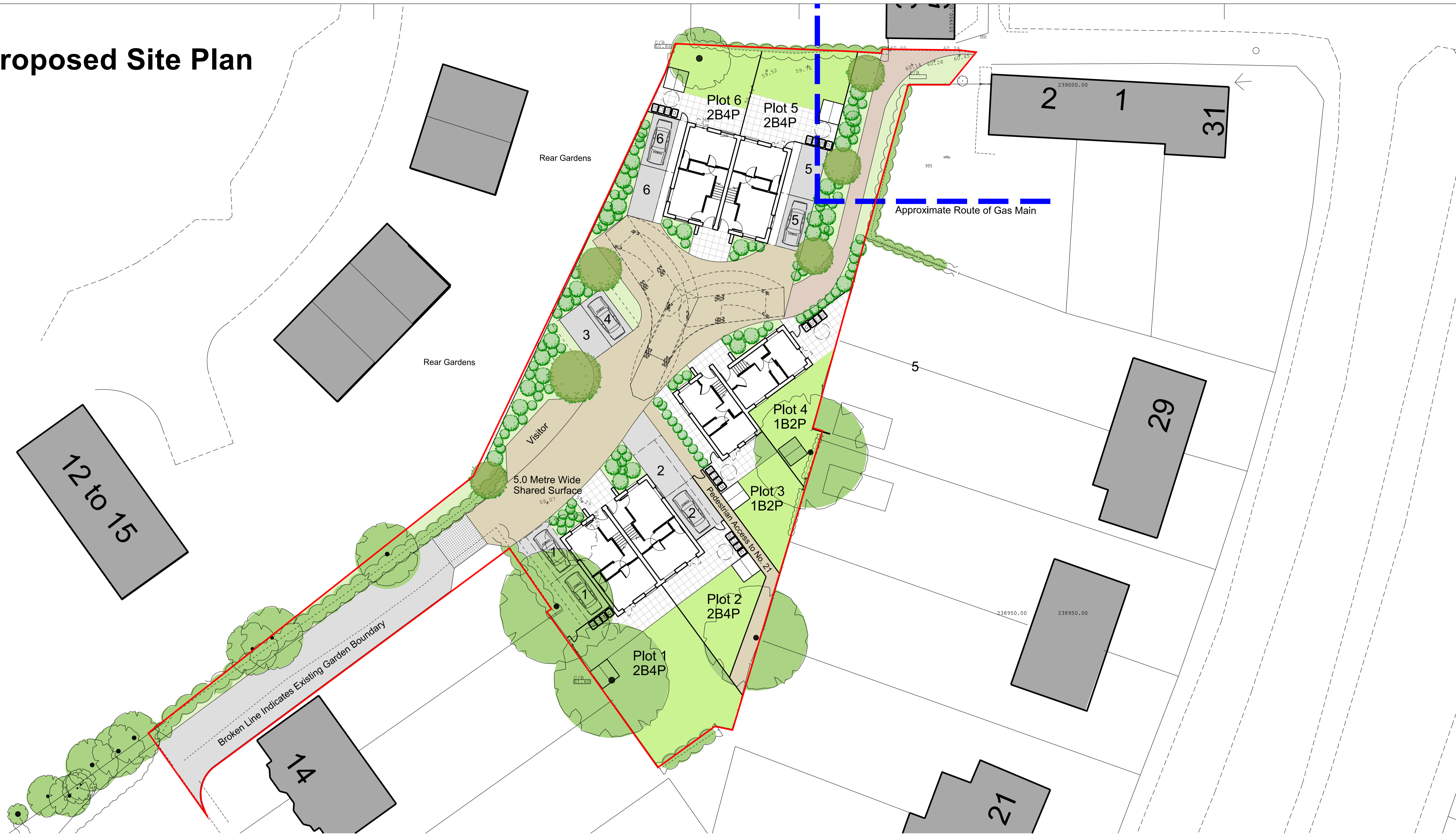

- Notes:**
- All dimensions to be verified on site by GENERAL CONTRACTOR and any discrepancies to be brought to the attention of the Architect prior to commencing work or setting out or preparing shop drawings.
  - Drawings not to be scaled. Work to figured dimensions only.
  - © copyright SAUNDERS BOSTON LIMITED. All rights reserved. This drawing remains the property of SAUNDERS BOSTON LIMITED at all times and may not be reproduced or copied in whole or in part without their prior written consent.
  - This drawing and related specifications are for use only in the stated location.
  - This drawing is to be read in conjunction with all other Consultants drawings and specifications.
  - Drainage has not been surveyed and all pipe locations and and below ground drainage runs are indicative

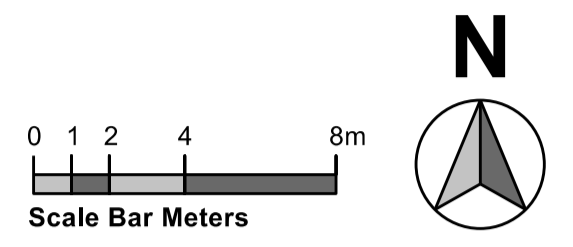

**2B4P Elevation**  
Plots 1 & 2 + Plots 5 & 6



**1B4P Elevation**  
Plots 3 & 4

**Schedule**  
 4No. 2B4P Houses with 2 No. Parking Spaces  
 2No. 1B2P Houses With 1 No. Parking Spaces  
**Site Total: 6 No. Houses**  
**Total Site Area: 0.19 Hectares**

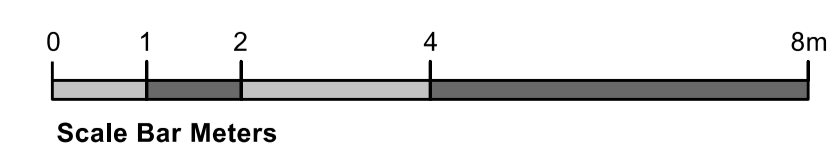

**PRELIM FOR COMMENT**

No.	Revision	Date	Chk	Auth
A	Number 21 Access Shown, General Revisions	30/3/2014	NDMG	NDMG

**FOR DISCUSSION**

Chartered Architects  
 119 Newmarket Road  
 Cambridge  
 CB5 9BA  
 Tel: (01223) 367733  
 E-mail: office@saundersboston.co.uk

**Saunders Boston**

Client: **Uttlesford District Council**

Job: **Catons Lane Saffron Walden**

Drawing: **Proposed Site Plan**

Scales	Date
1:200 @ A1, 1:400 @ A3 1:100 @ A1, 1:200 @ A3	March 2014
Number	Authorised
<b>1343-SK-001</b>	LG NDMG